

# 710

## Hangebords art. PL-079

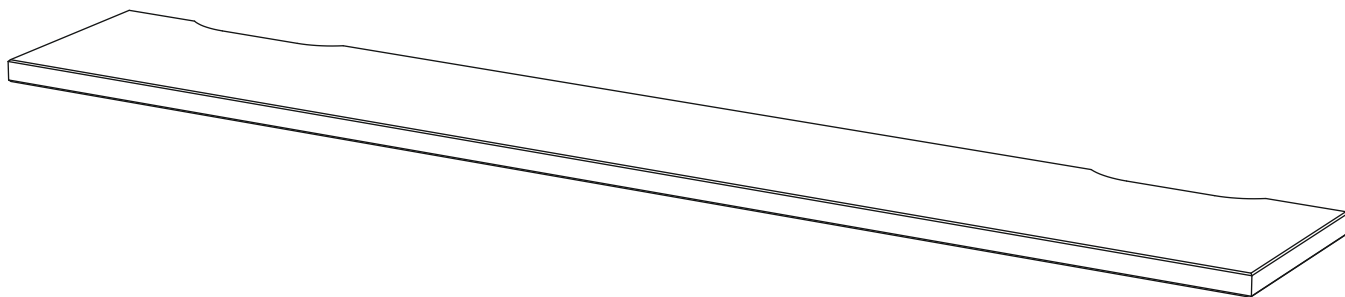
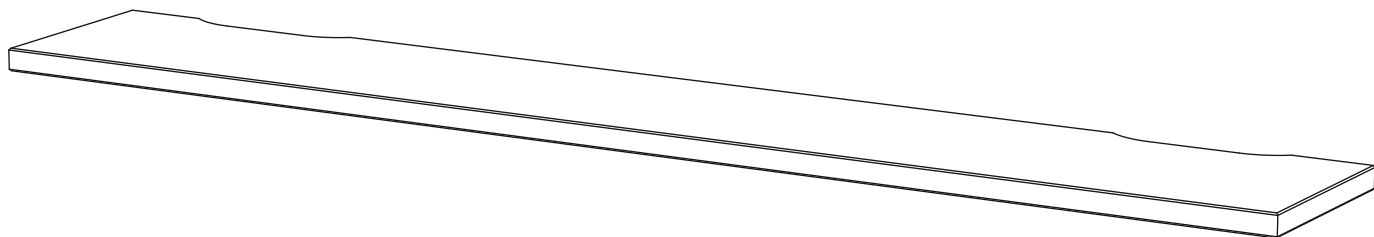

**Assembled size / Maße aufgebaut :**

**Thickness / Dicke : 20 mm.**

**Width / Breite : 1200 mm.**

**Depth / Tiefe : 185 mm.**

This unit can be  
assembled by two persons.

Aufbau mit zwei Personen.

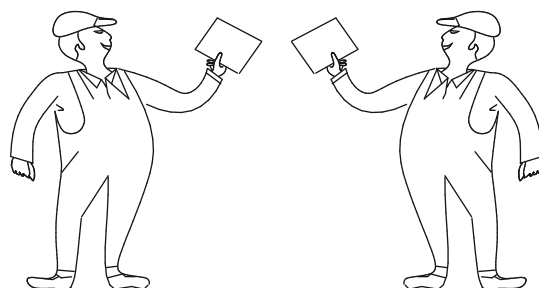

The necessary tools  
(not included)

Die dazu benötigten Werkzeuge  
(ausschliesslich)

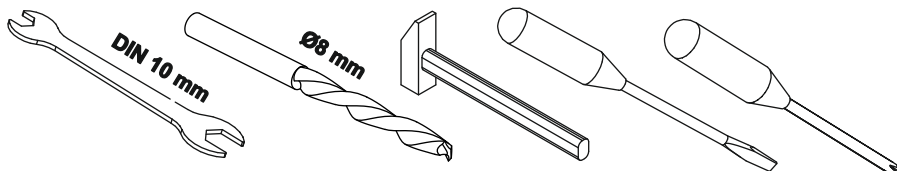

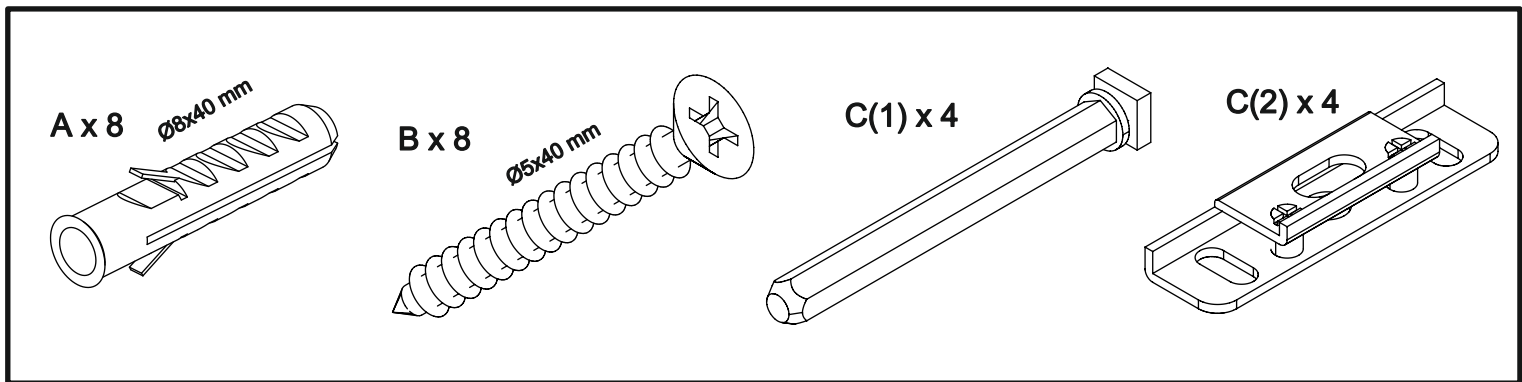
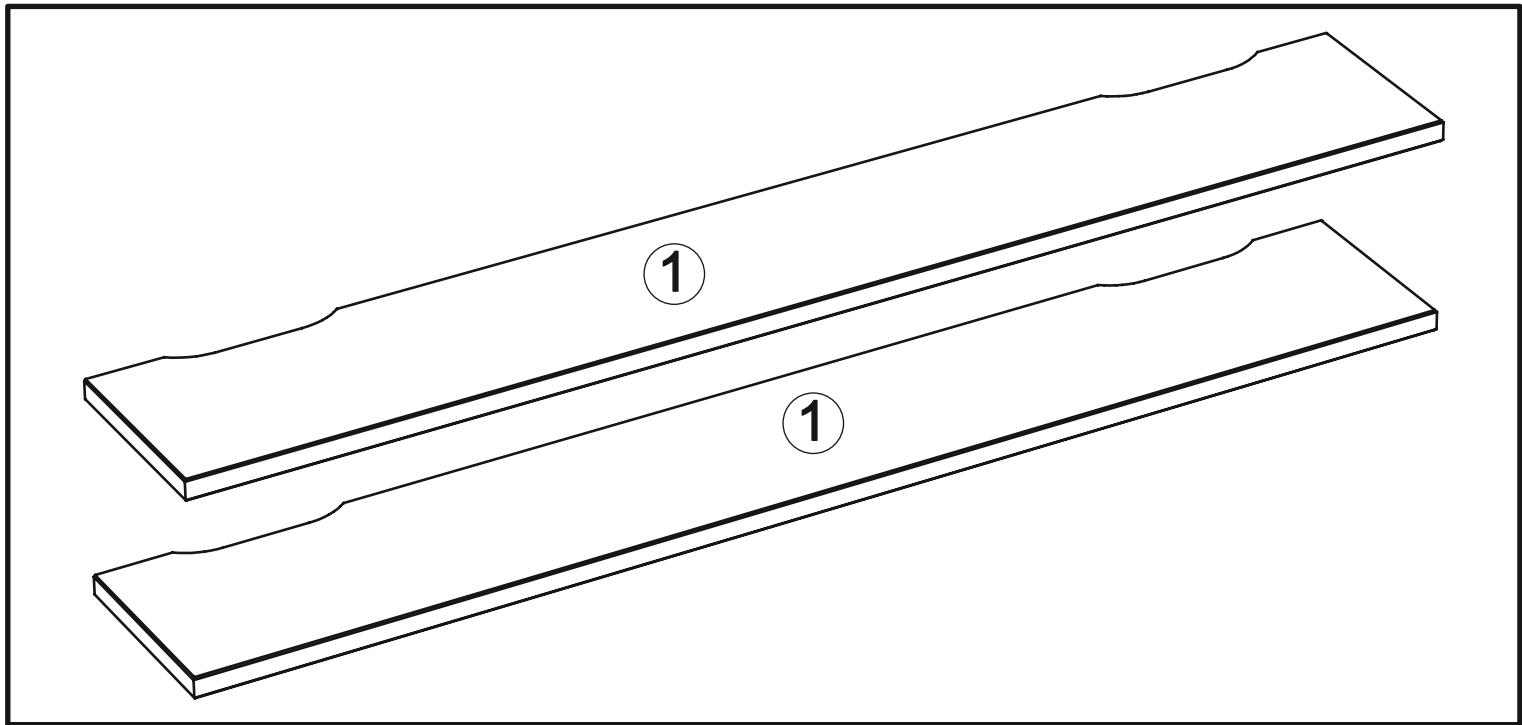

# WALL WAND

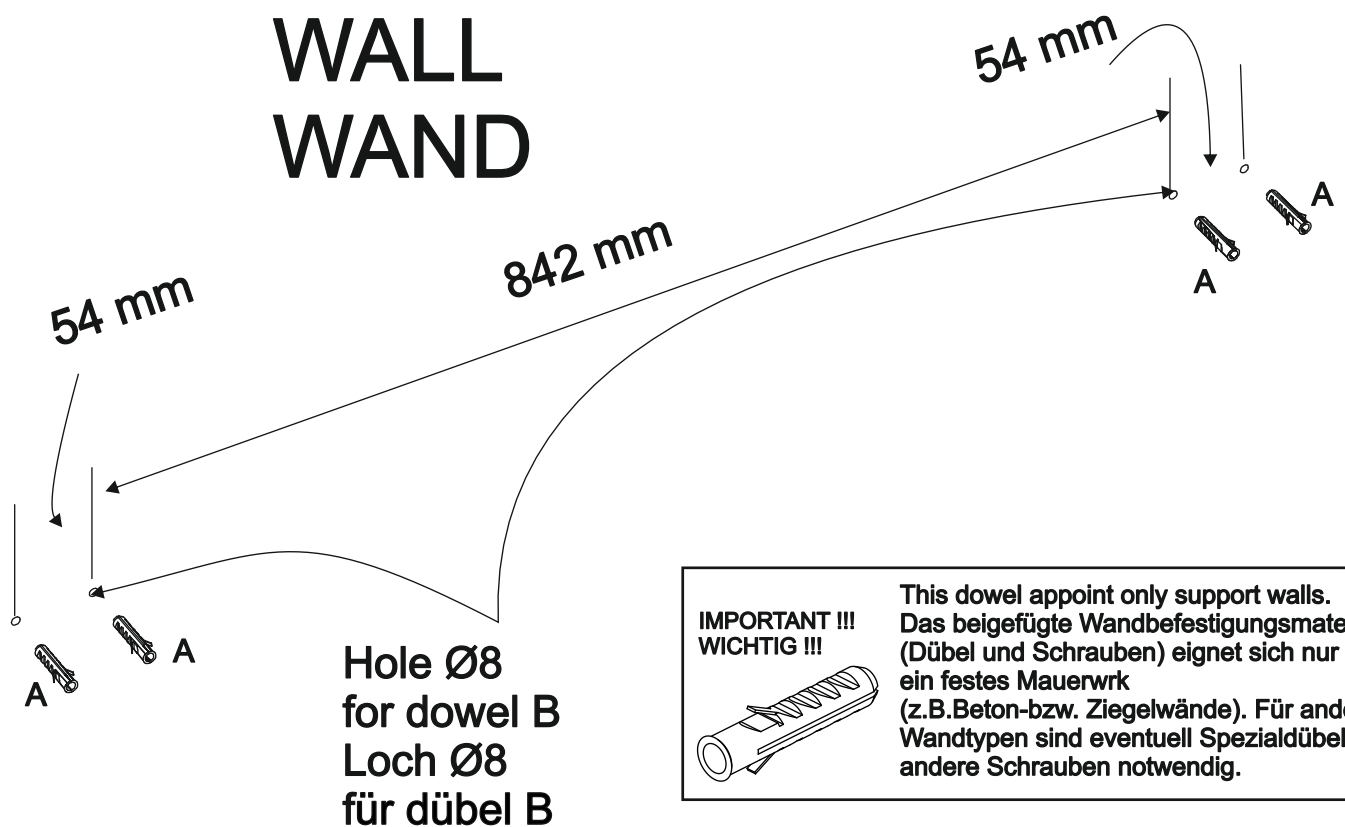

**IMPORTANT !!!  
WICHTIG !!!**

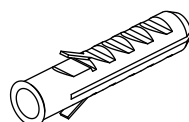

This dowel appoint only support walls.  
Das beigefügte Wandbefestigungsmaterial  
(Dübel und Schrauben) eignet sich nur für  
ein festes Mauerwerk  
(z.B. Beton- bzw. Ziegelwände). Für andere  
Wandtypen sind eventuell Spezialdübel und  
andere Schrauben notwendig.

2

B x 4

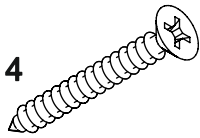

C(1) x 2

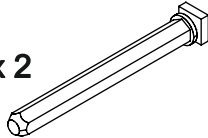

C(2) x 2

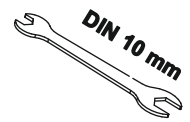
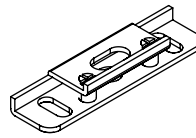

1.

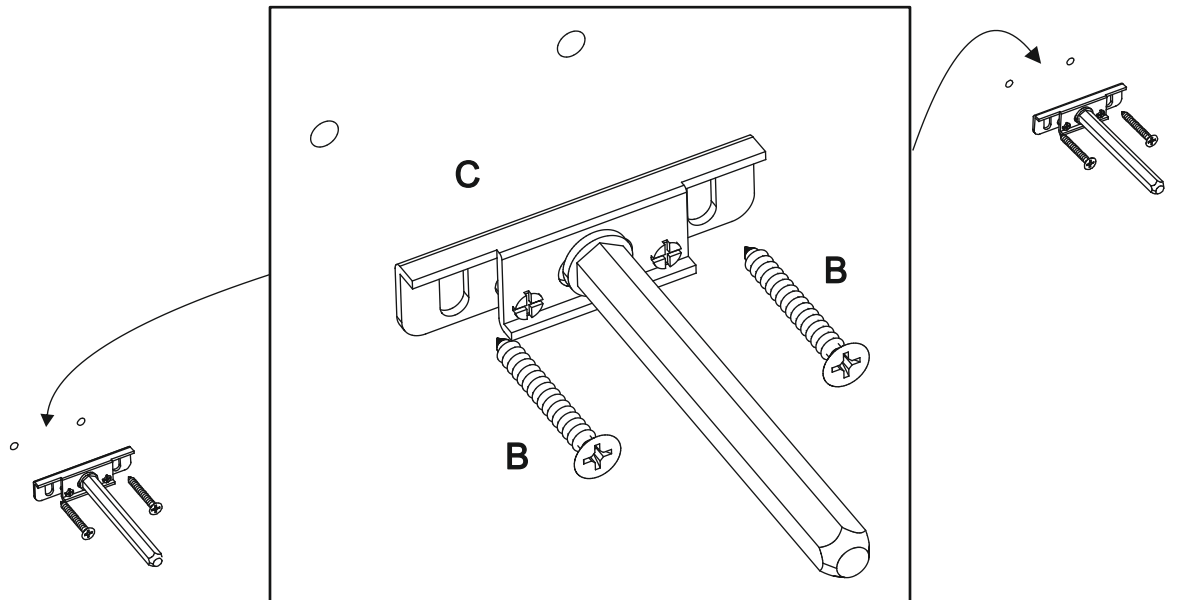
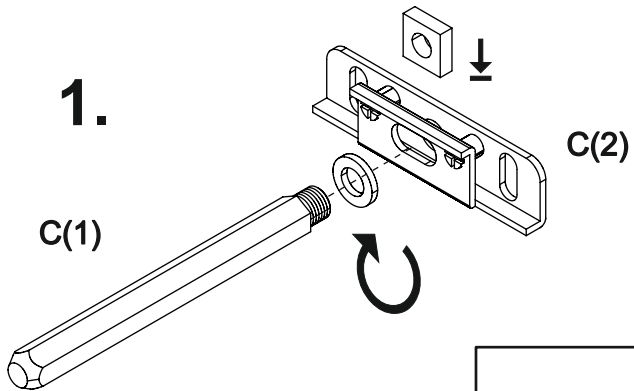

3

