

**Assembled size / Maße aufgebaut :**

**Height / Höhe : 2241 mm.**

**Width / Breite : 2505 mm.**

**Depth / Tiefe : 587 mm.**

**This unit can be assembled by two persons.**

**Aufbau mit zwei Personen.**

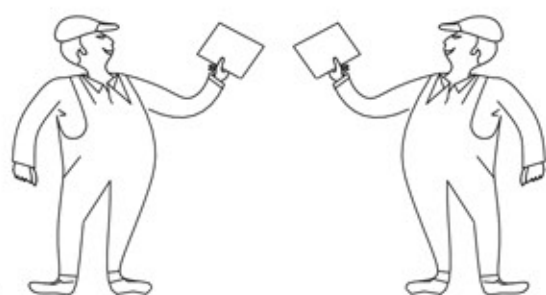

**Beachten Sie bitte:**  
**Massiv-Holz ist ein organisches Material und passt sich den jeweiligen Umweltbedingungen an.**  
**Leichter Verzug, Haarrisse und Oberflächendetails sind daher kein Reklamationsgrund,**  
**sondern ein Qualitätsmerkmal des Materials.**

**The necessary tools  
(not included)**

**Die dazu benötigten Werkzeuge  
(ausschliesslich)**

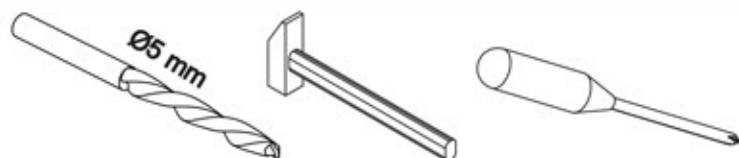

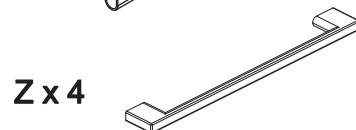
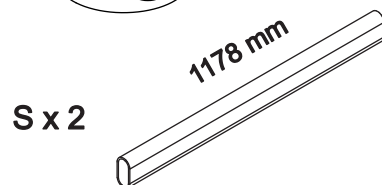
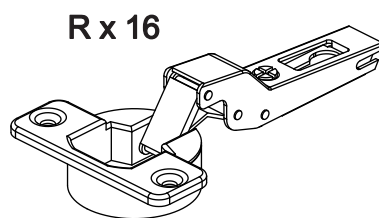
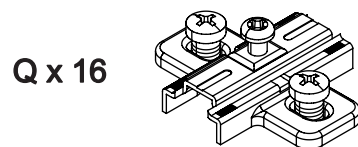
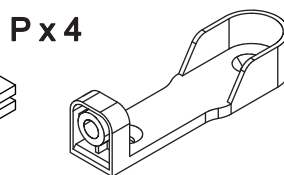
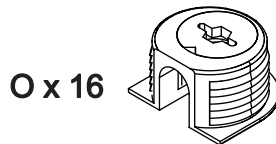
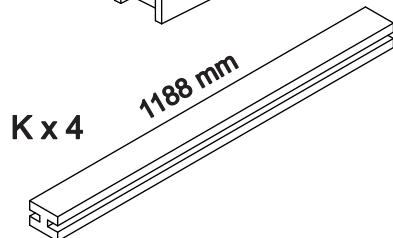
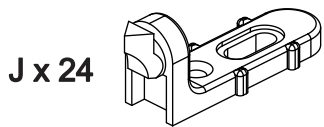
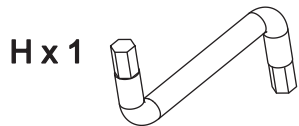
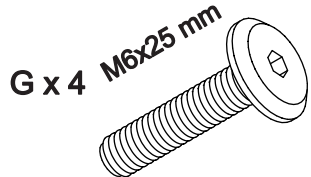
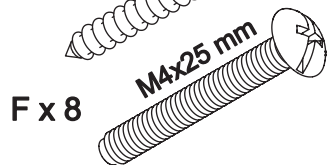
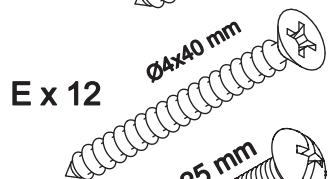
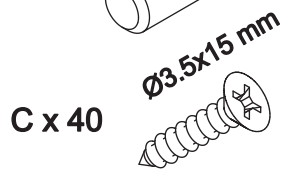
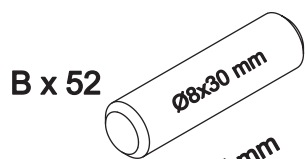
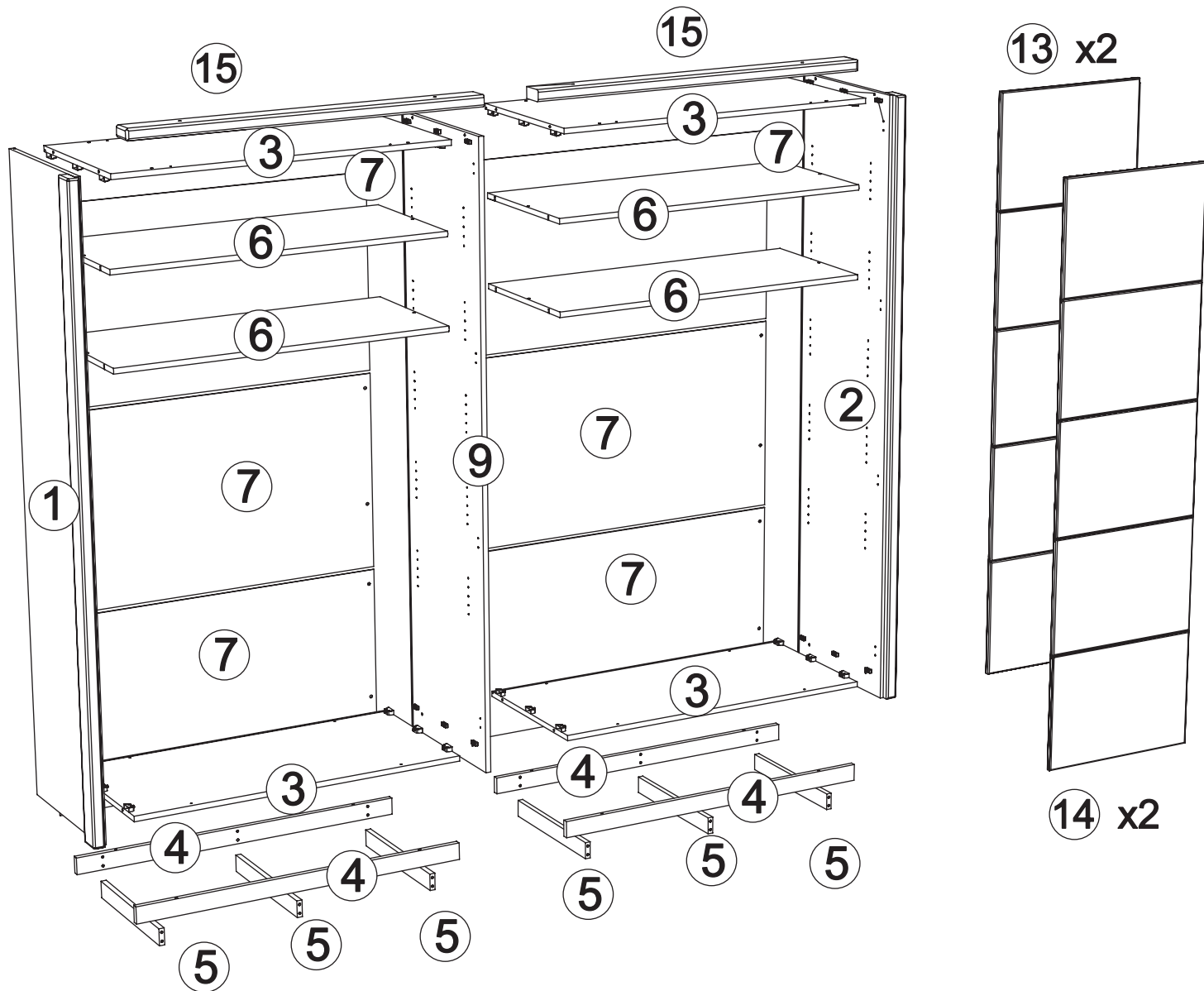

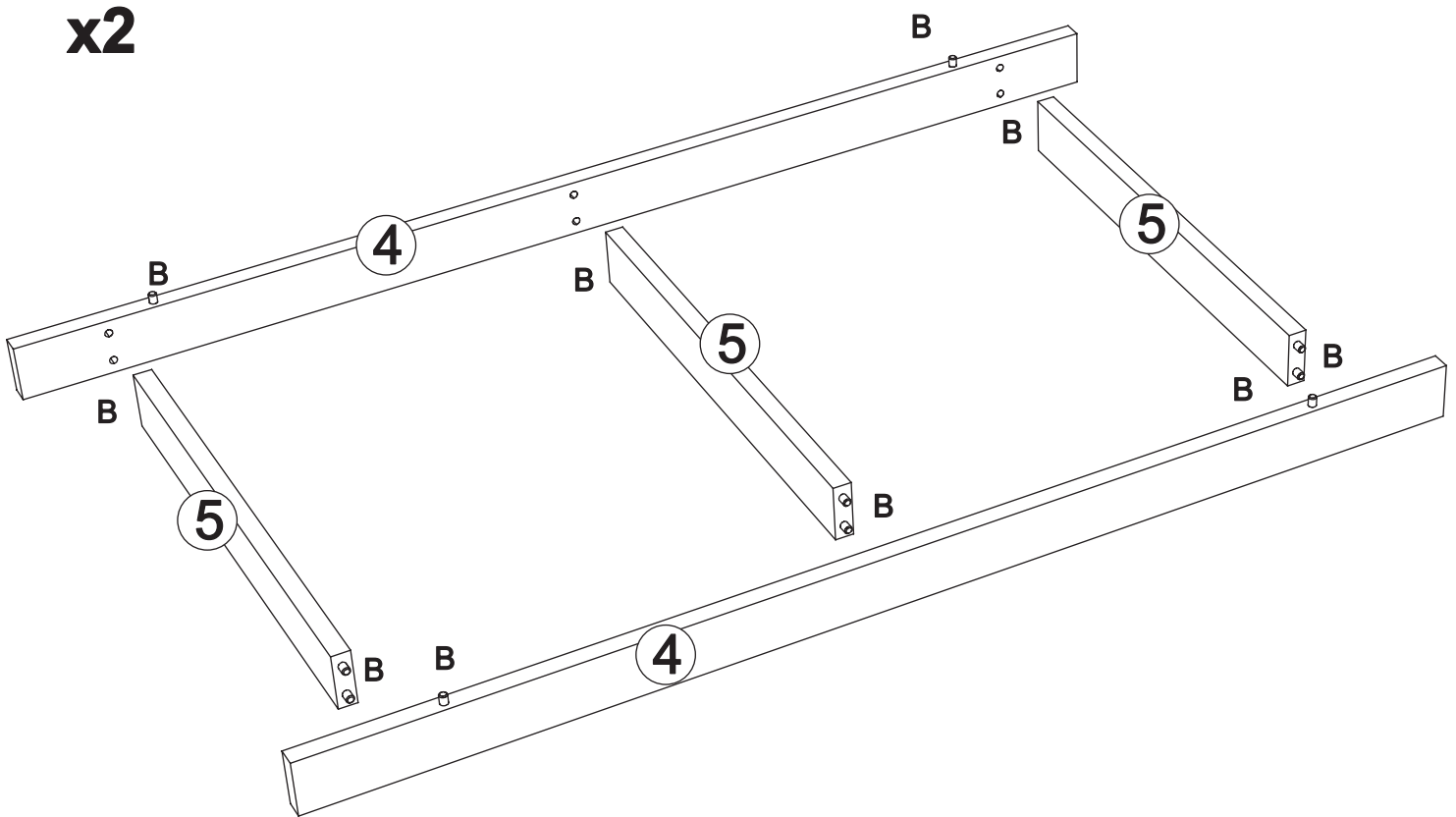
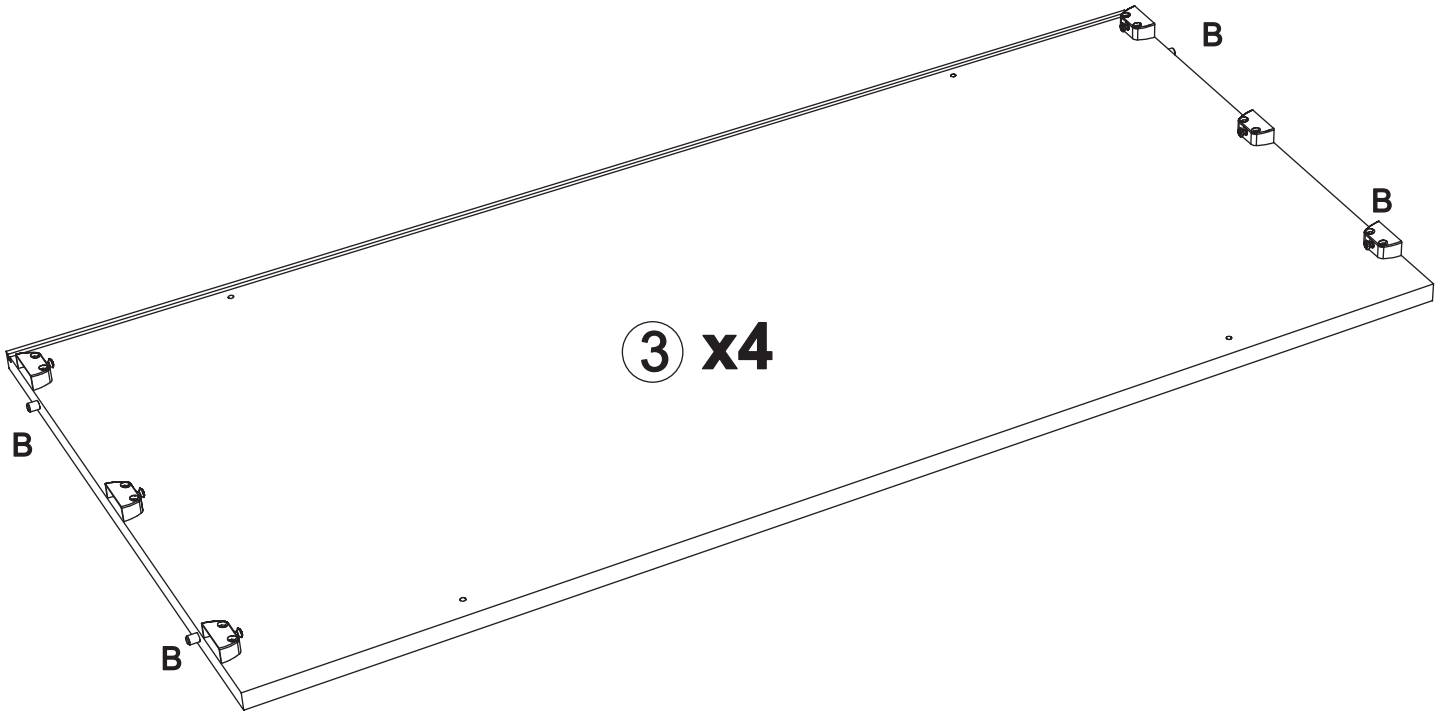

3

Ex 8

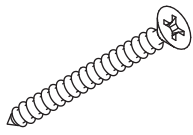

x2

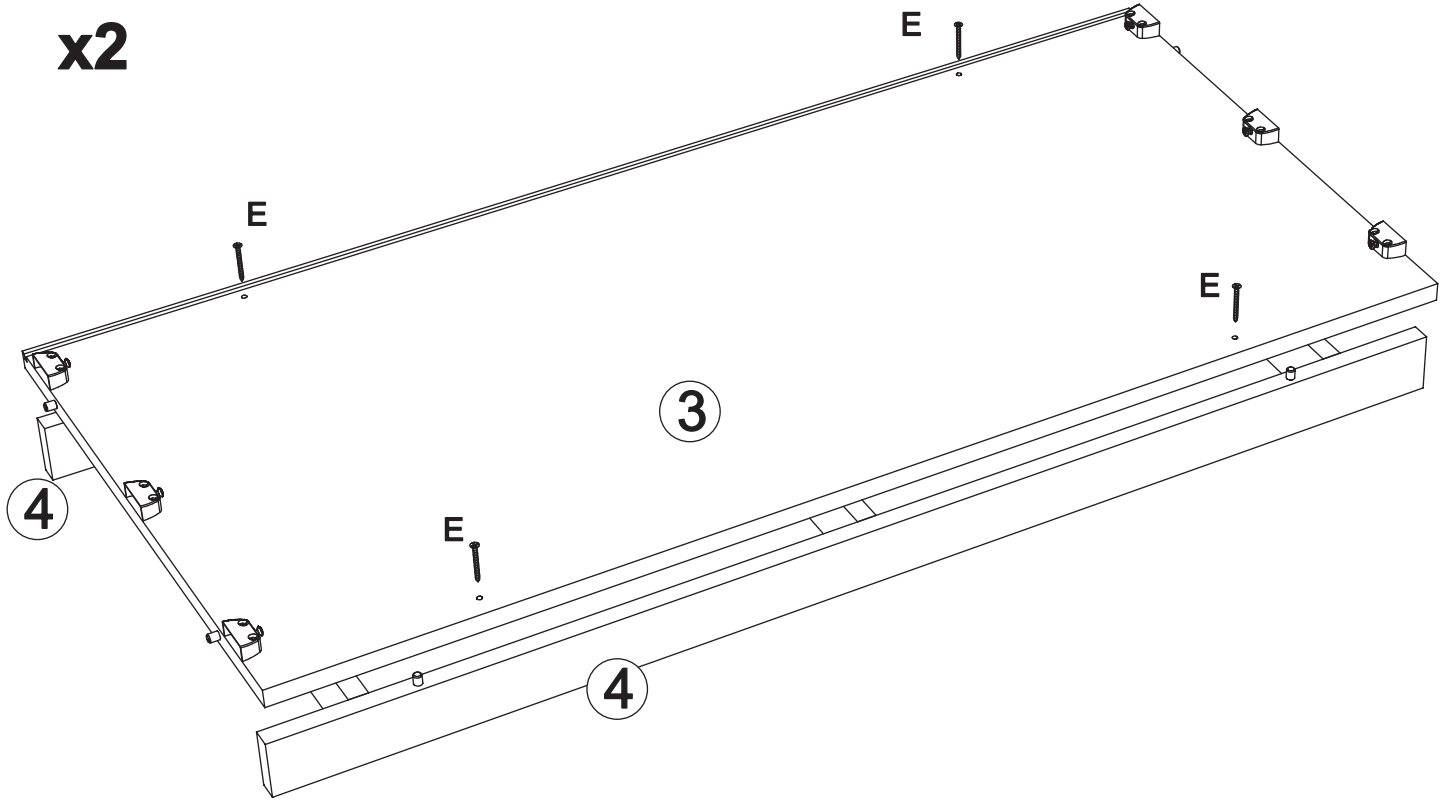

4

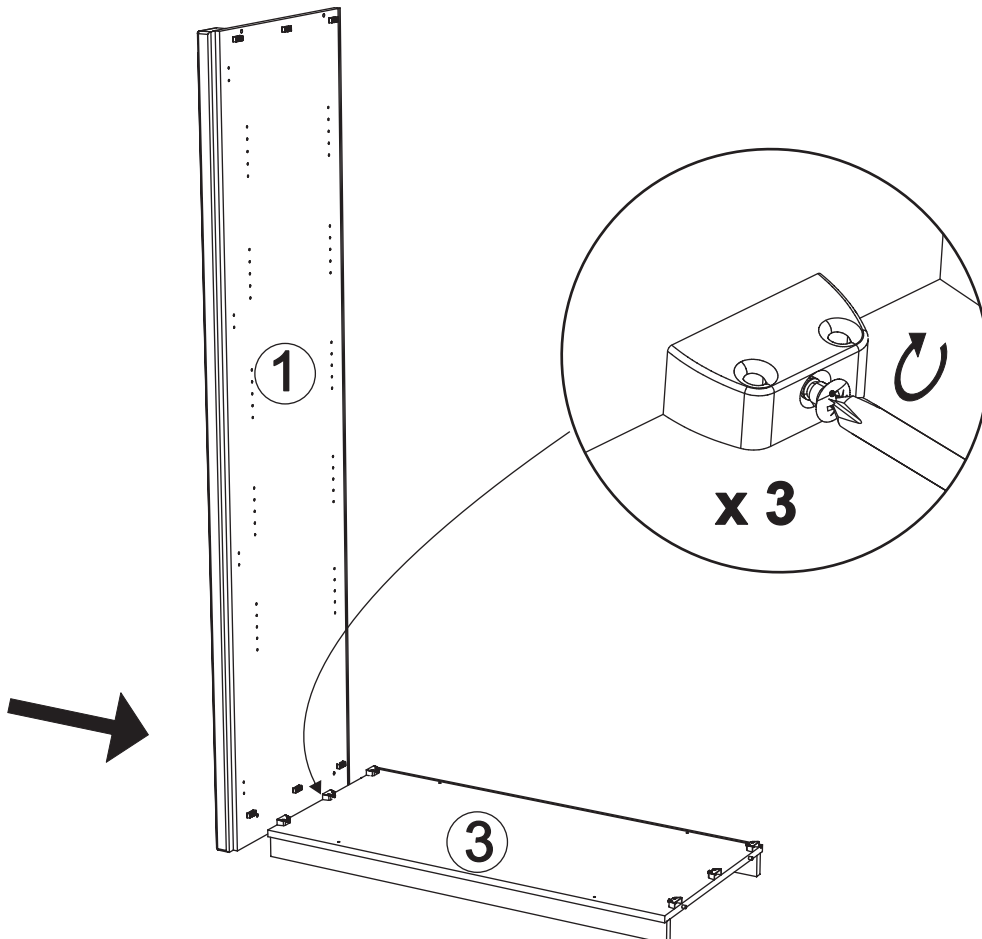

5

D x 12

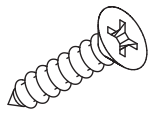

J x 6

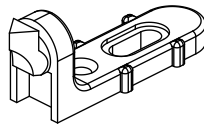

K x 2

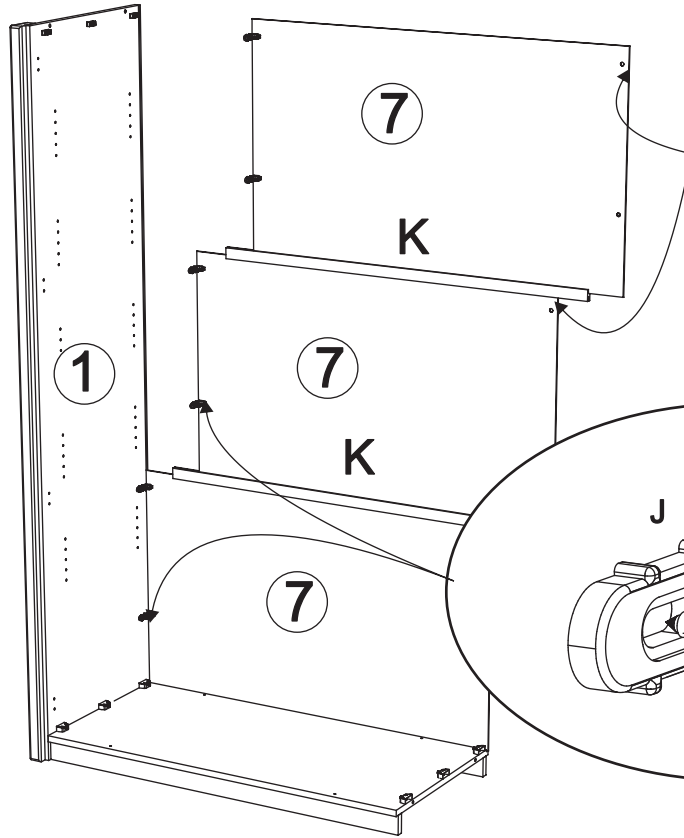
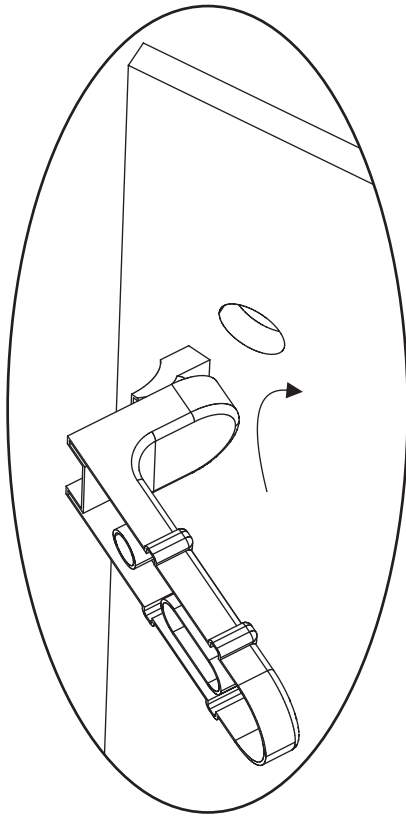
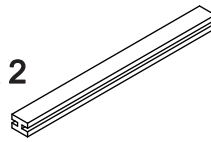

!!! Achtung  
Lochposition

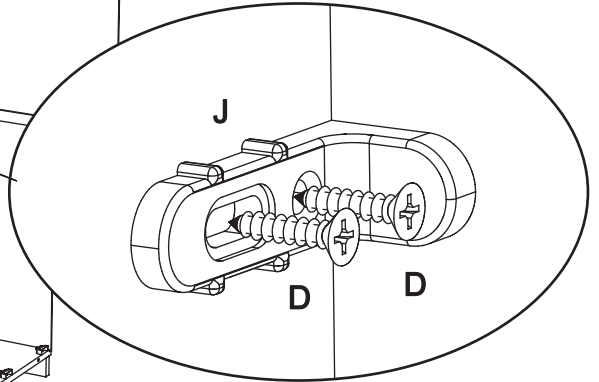

6

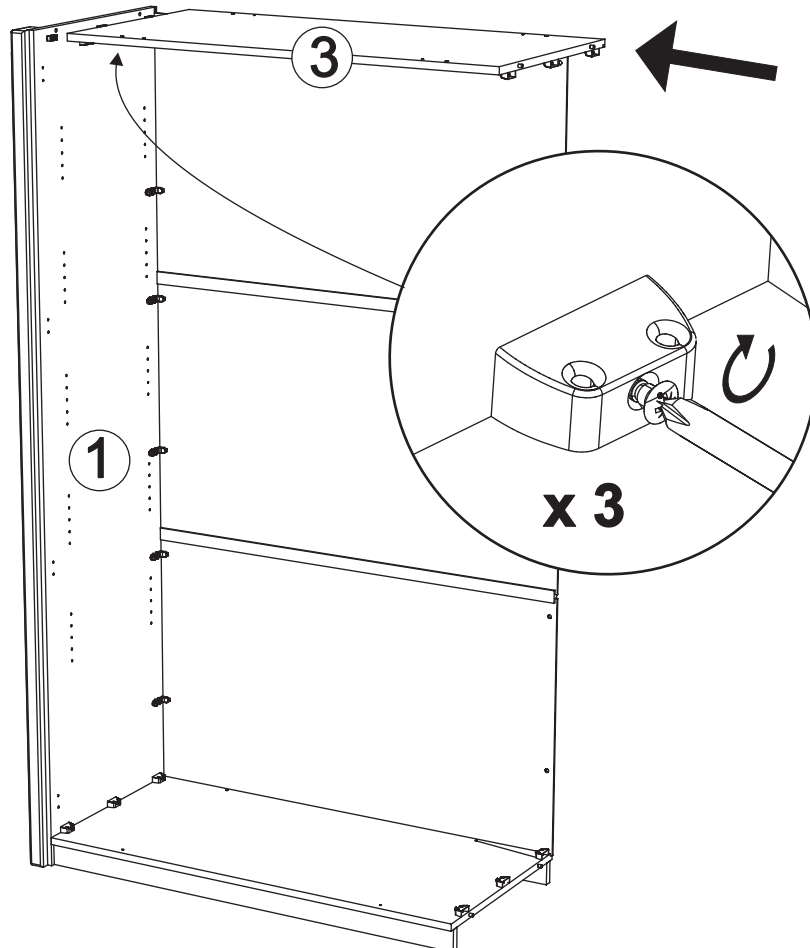

7

D x 12

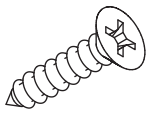

J x 6

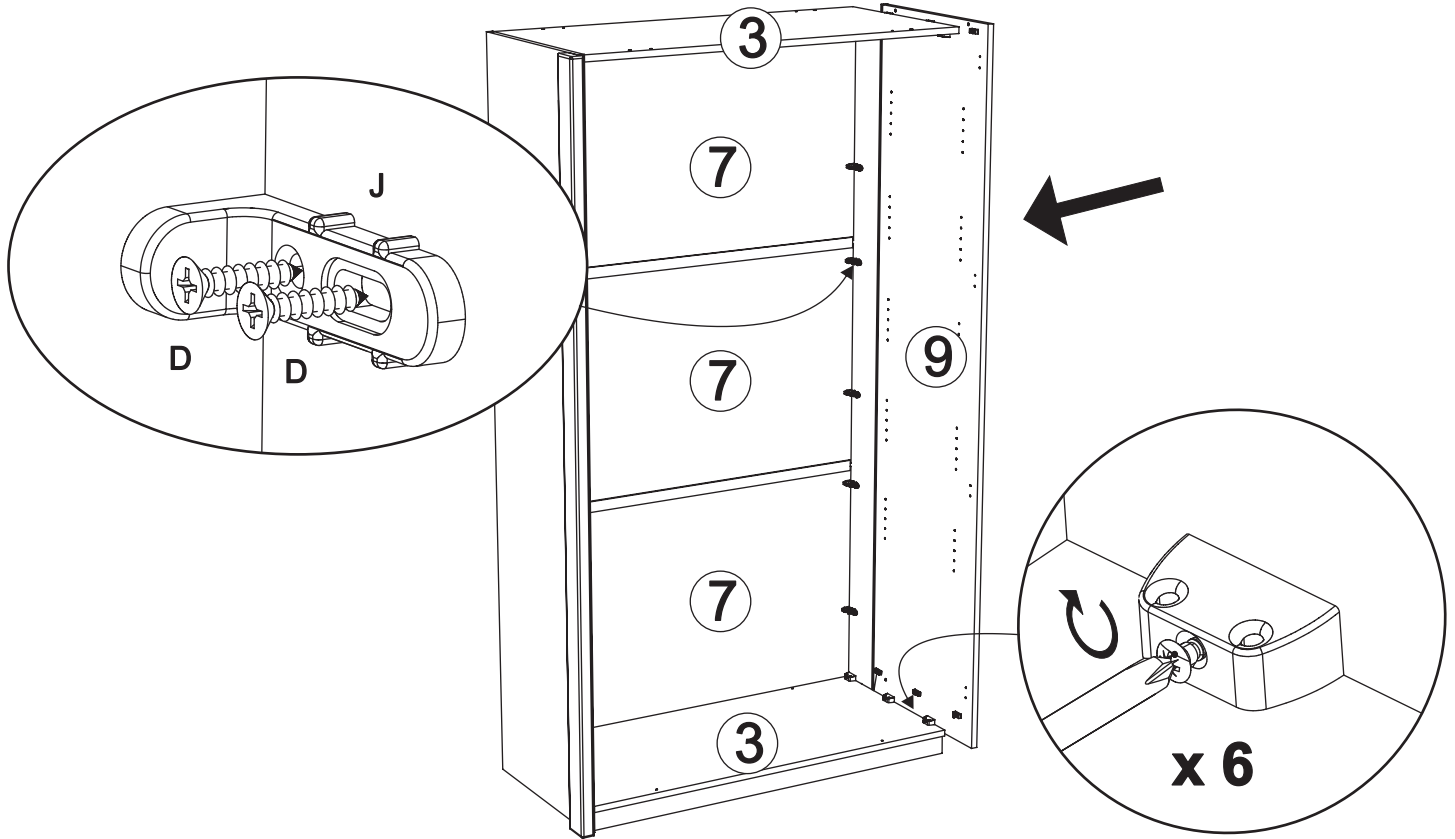
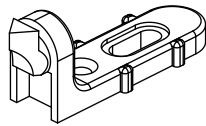

8

D x 12

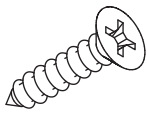

J x 6

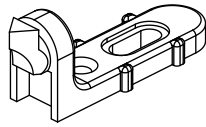

K x 2

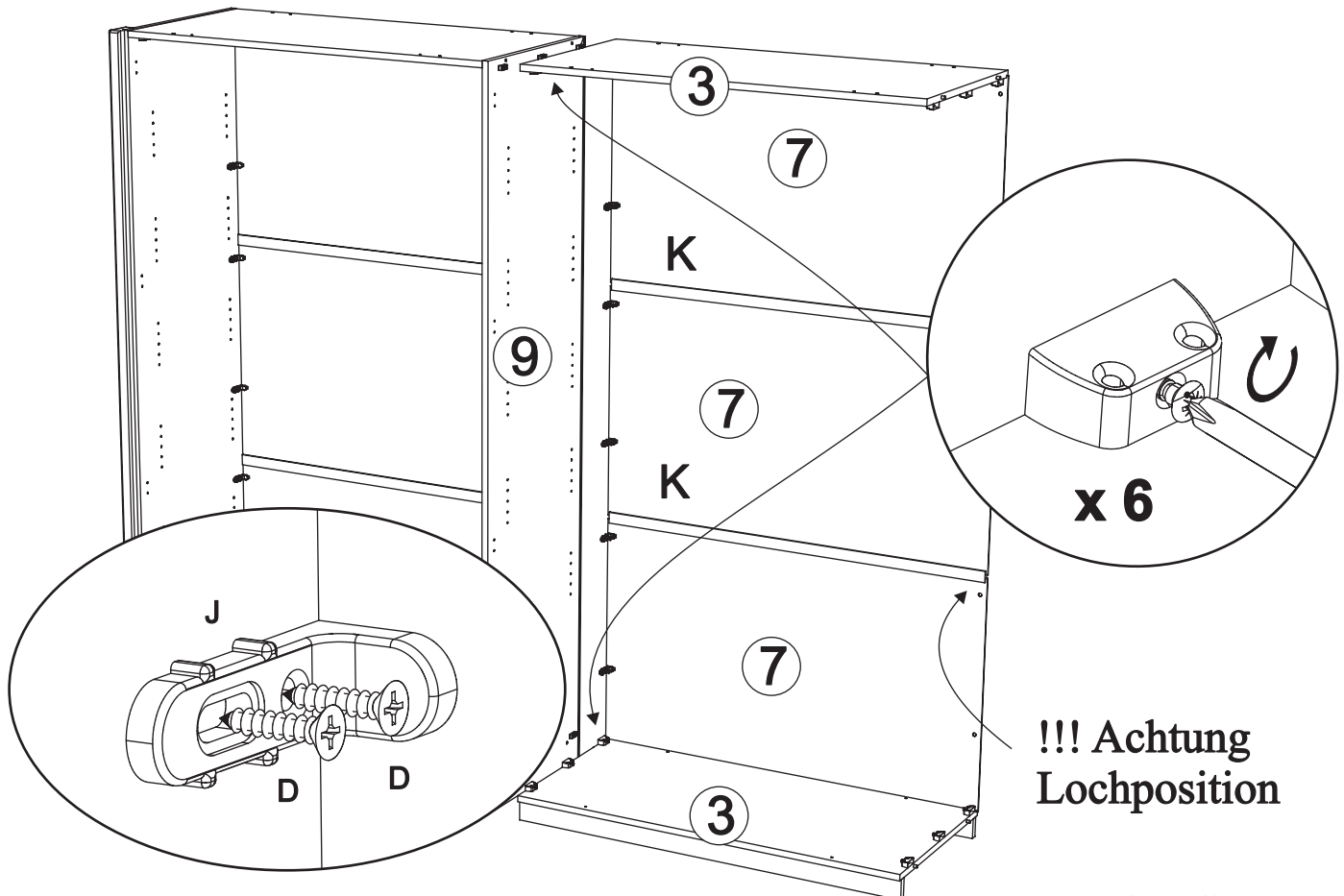
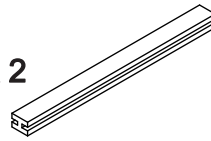

9

D x 12

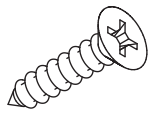

J x 6

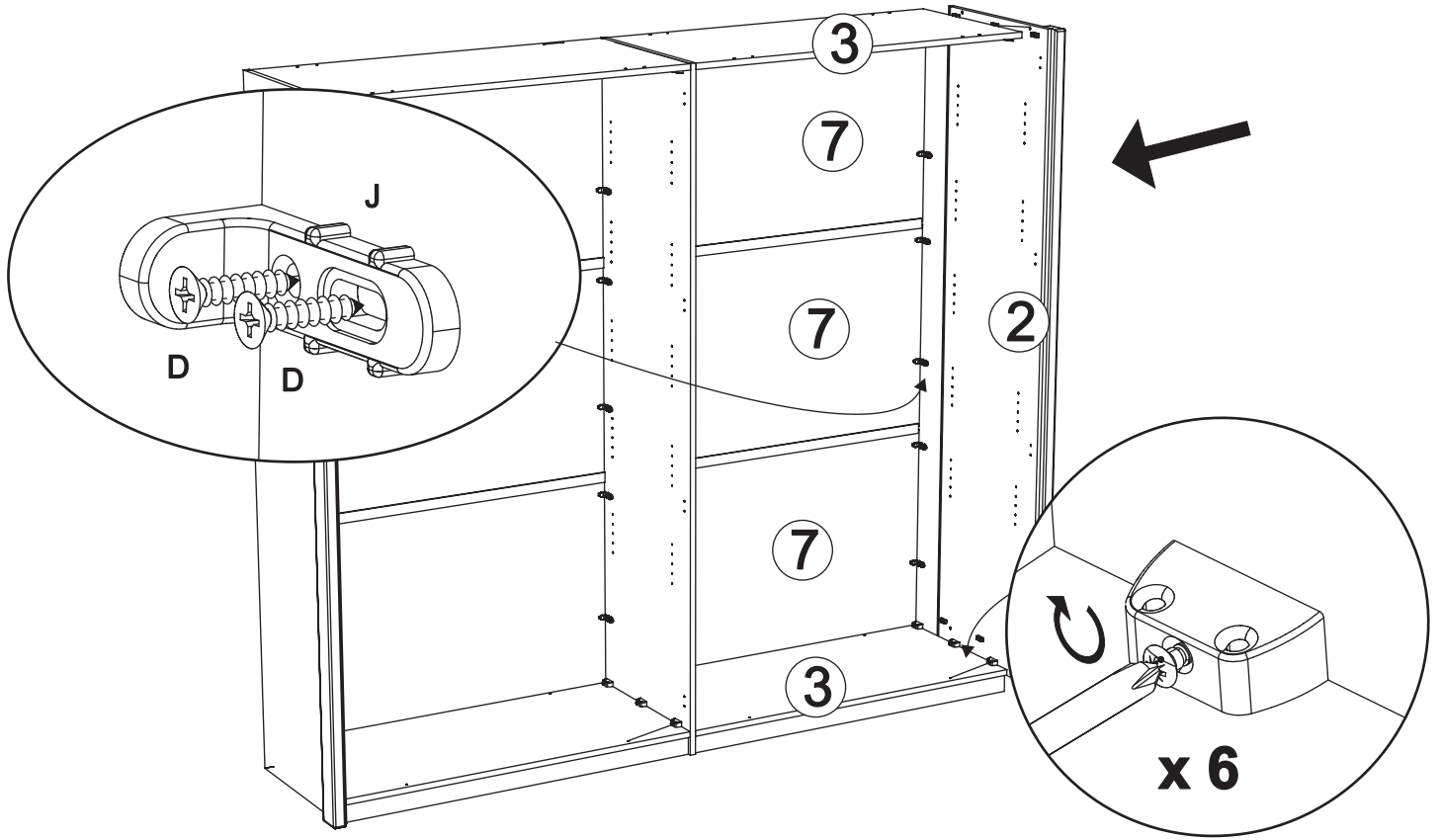
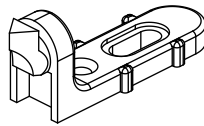

10

B x 4

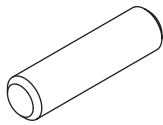

E x 4

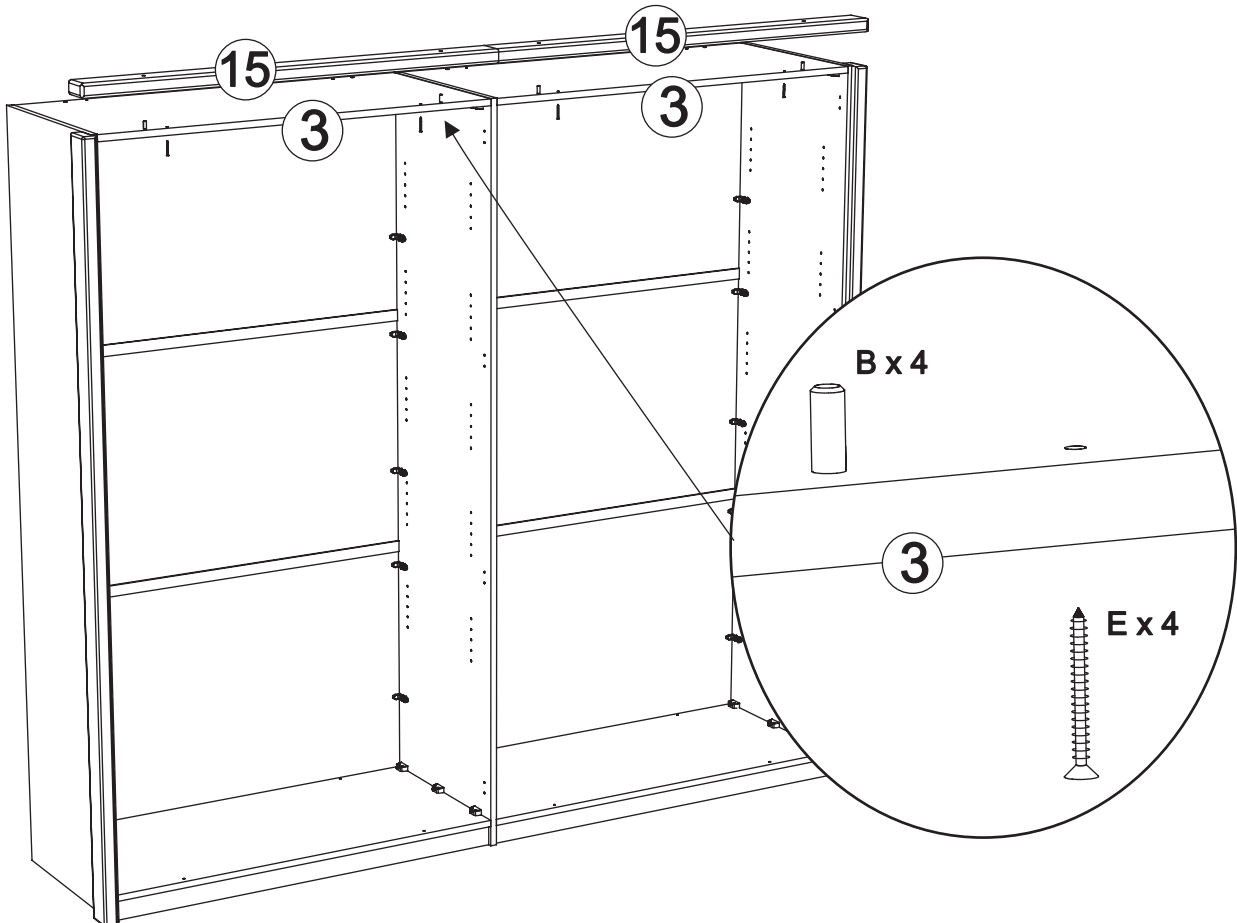
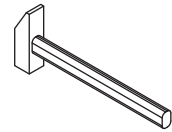
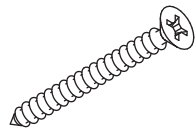

11

M x 16

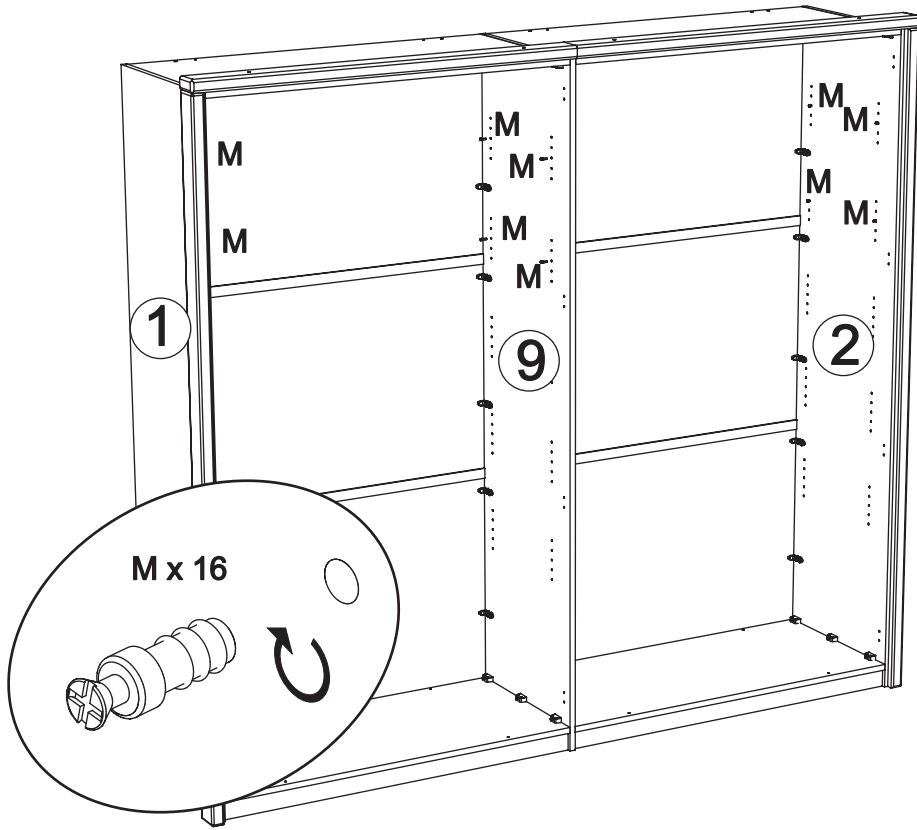
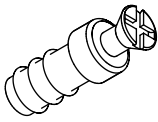

12

O x 16

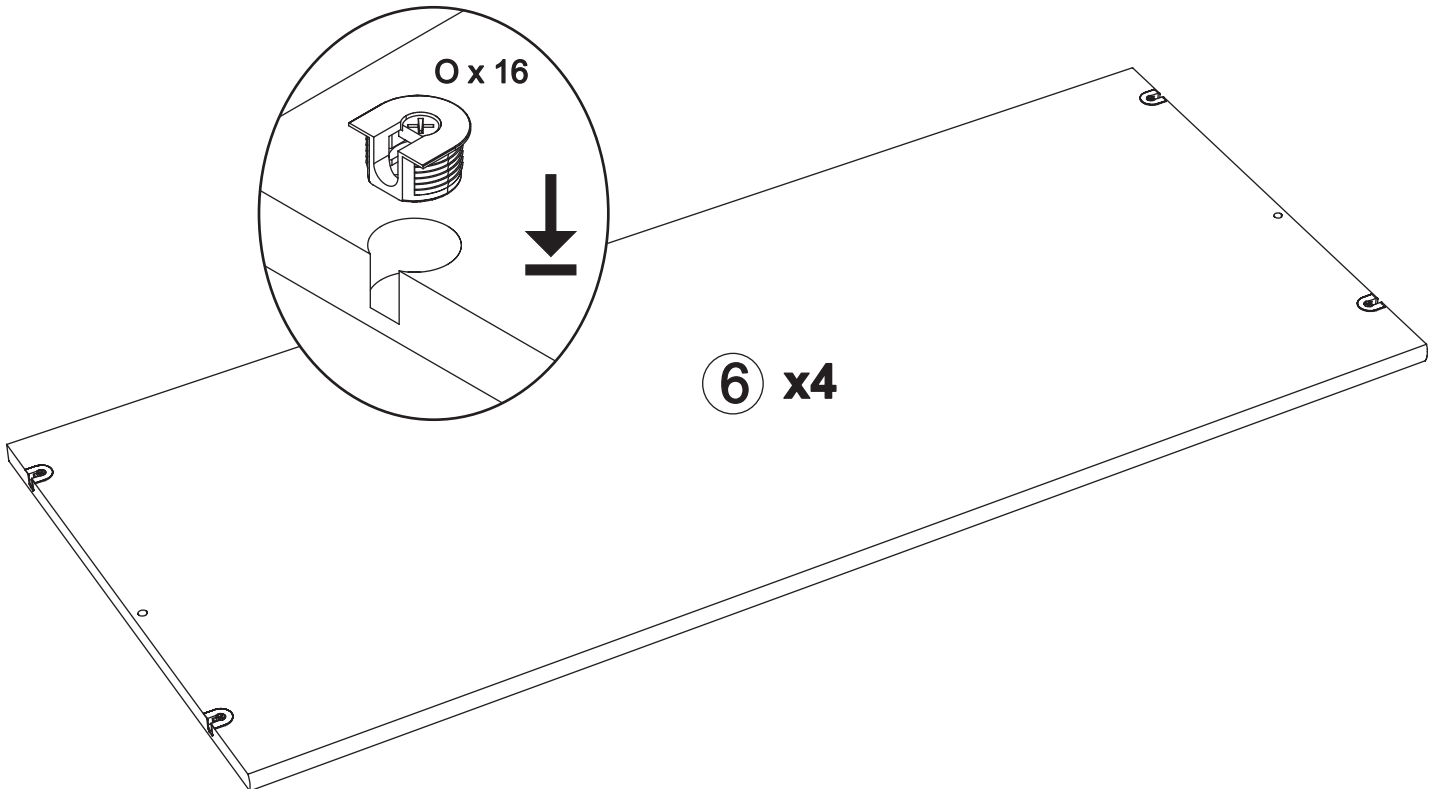
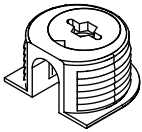



13

P x 4

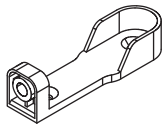

G x 4

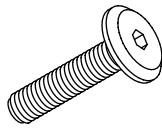

H x 1

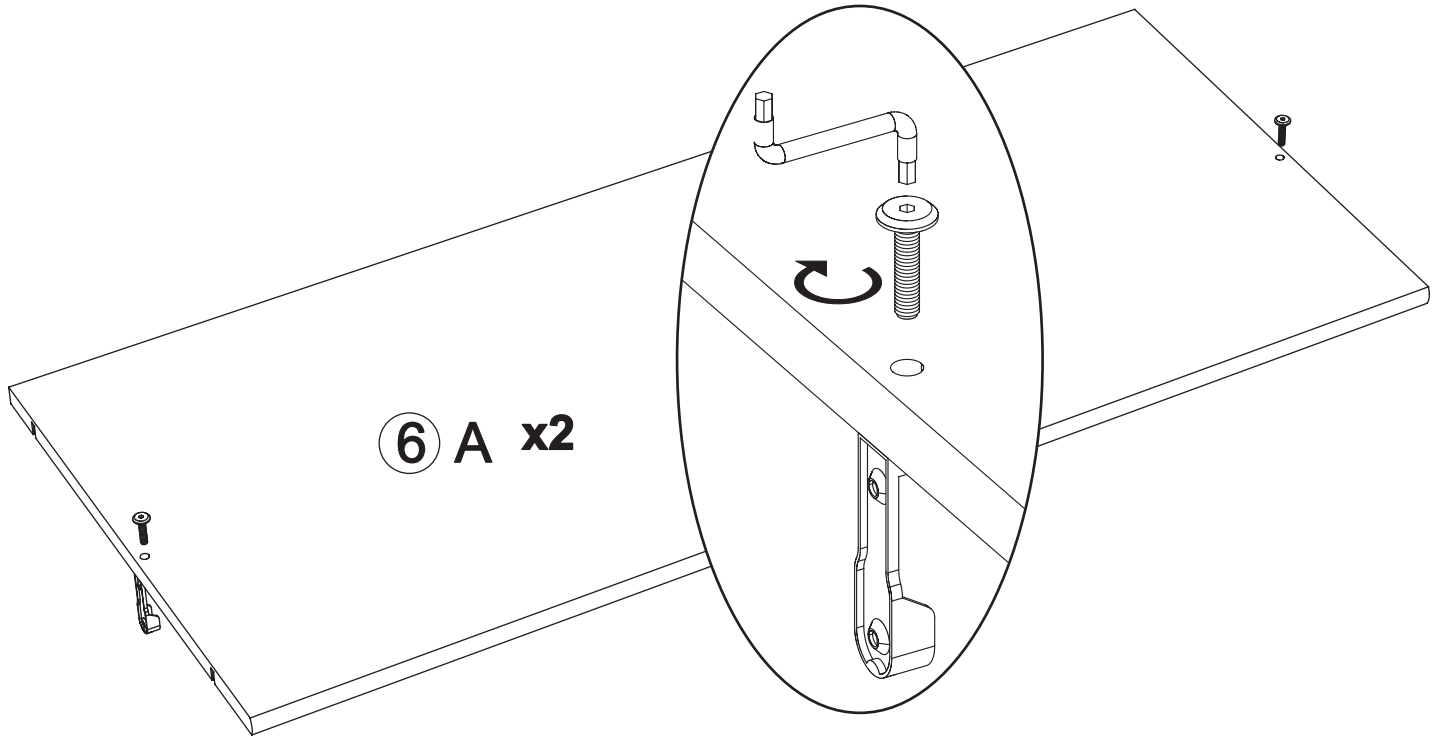
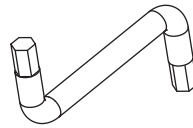

14

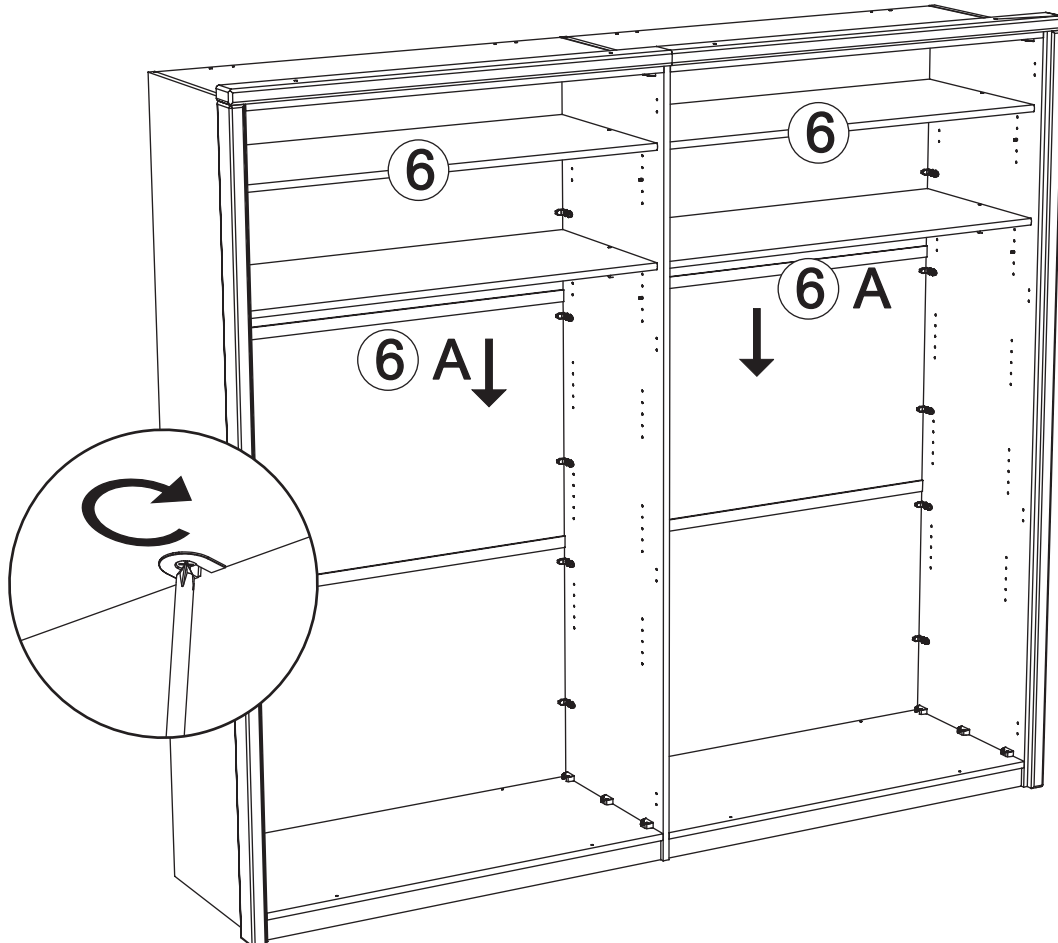

15

C x 8

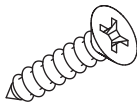

S x 2

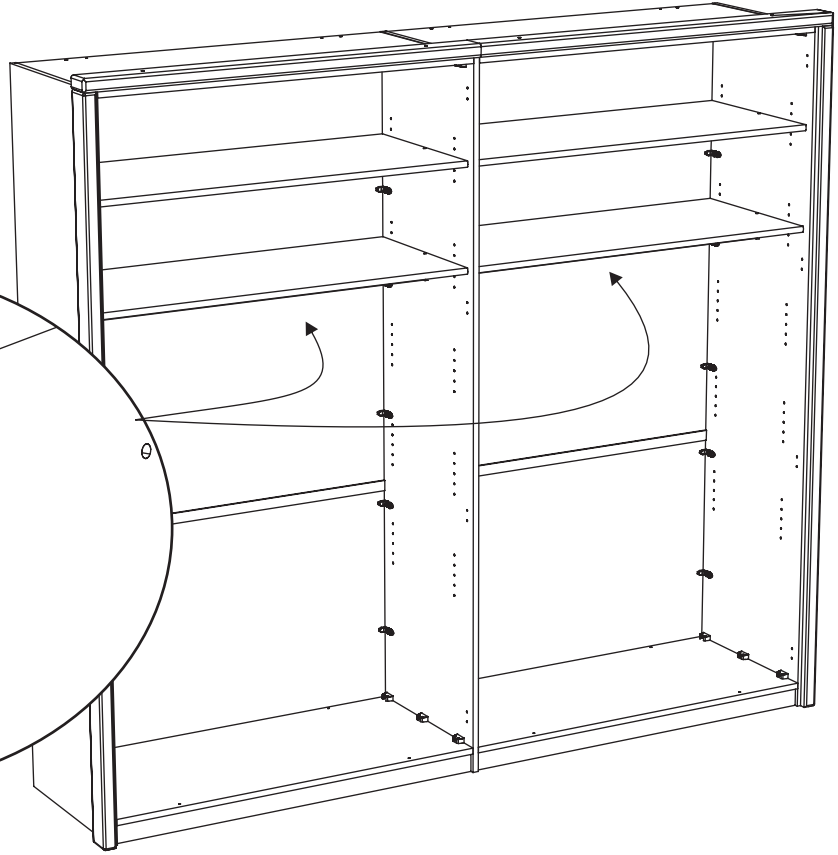
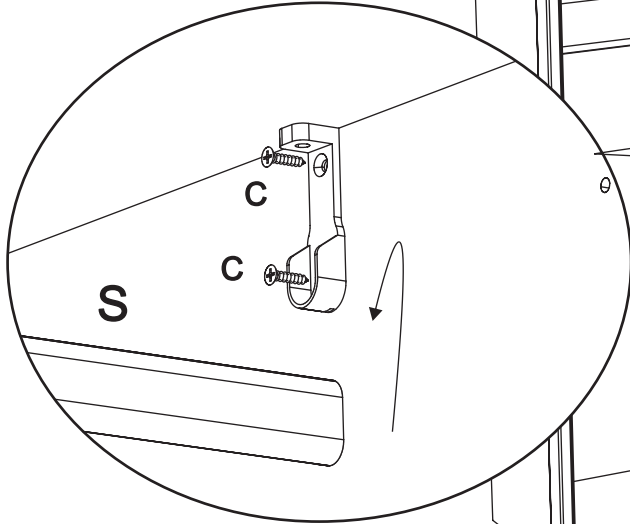
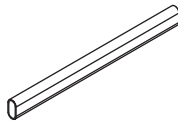

16

Q x 16

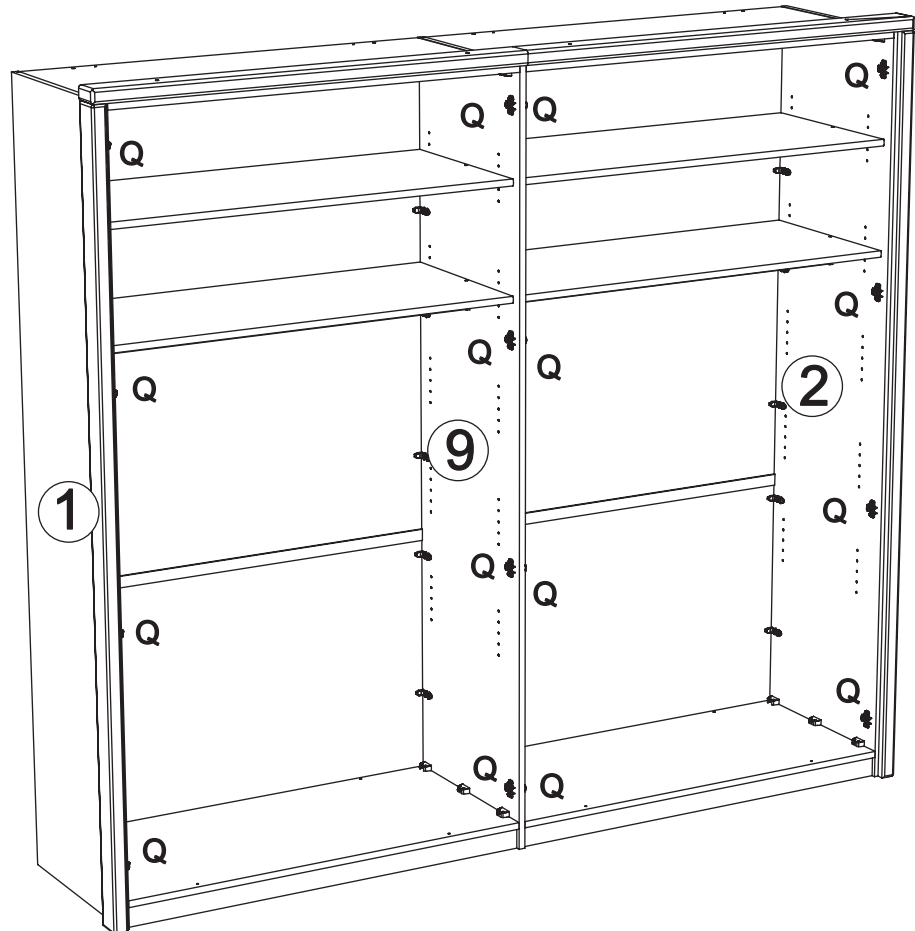
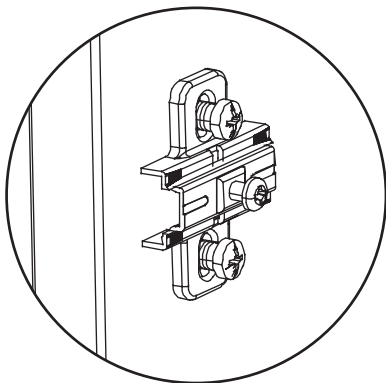
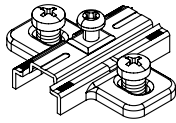

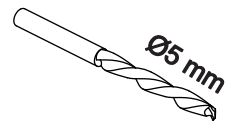
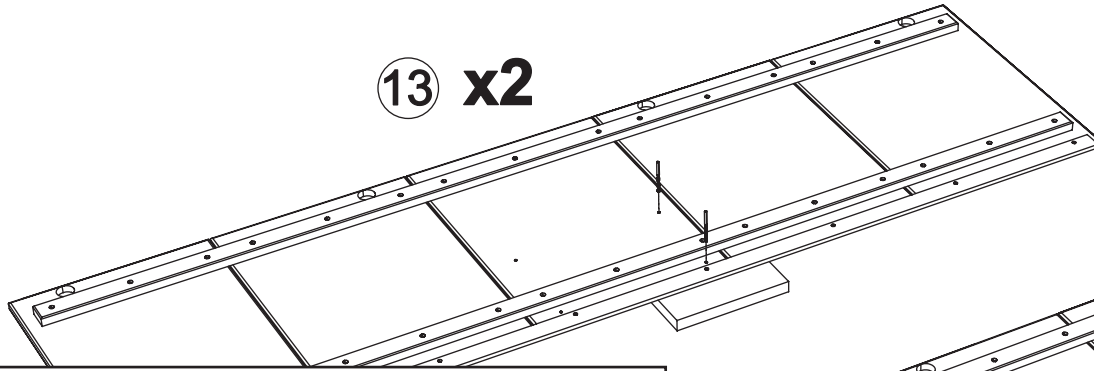
**17****13 x2**

**!!! ACHTUNG:**  
 Bei der MONTAGE DER GRIFFE  
 unbedingt darauf achten, dass beim  
 Nachbohren oder durchstechen der  
 vorgebohrten Löcher von vorne  
 ein Holzstück oder ähnliches  
 gegen gehalten wird. Damit  
 ein ausspalten verhindert wird.  
 Aufpassen, dass die richtigen  
 Löcher verwendet werden.

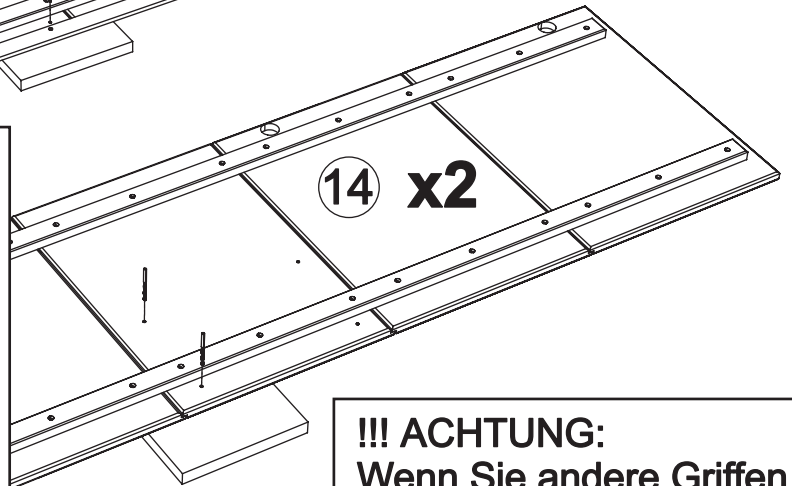
**14 x2**

**!!! ACHTUNG:**  
 Wenn Sie andere Griffen  
 benutzen, Bohrstelle  
 können anderorte sein.

**18**

C x 32

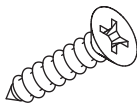

R x 16

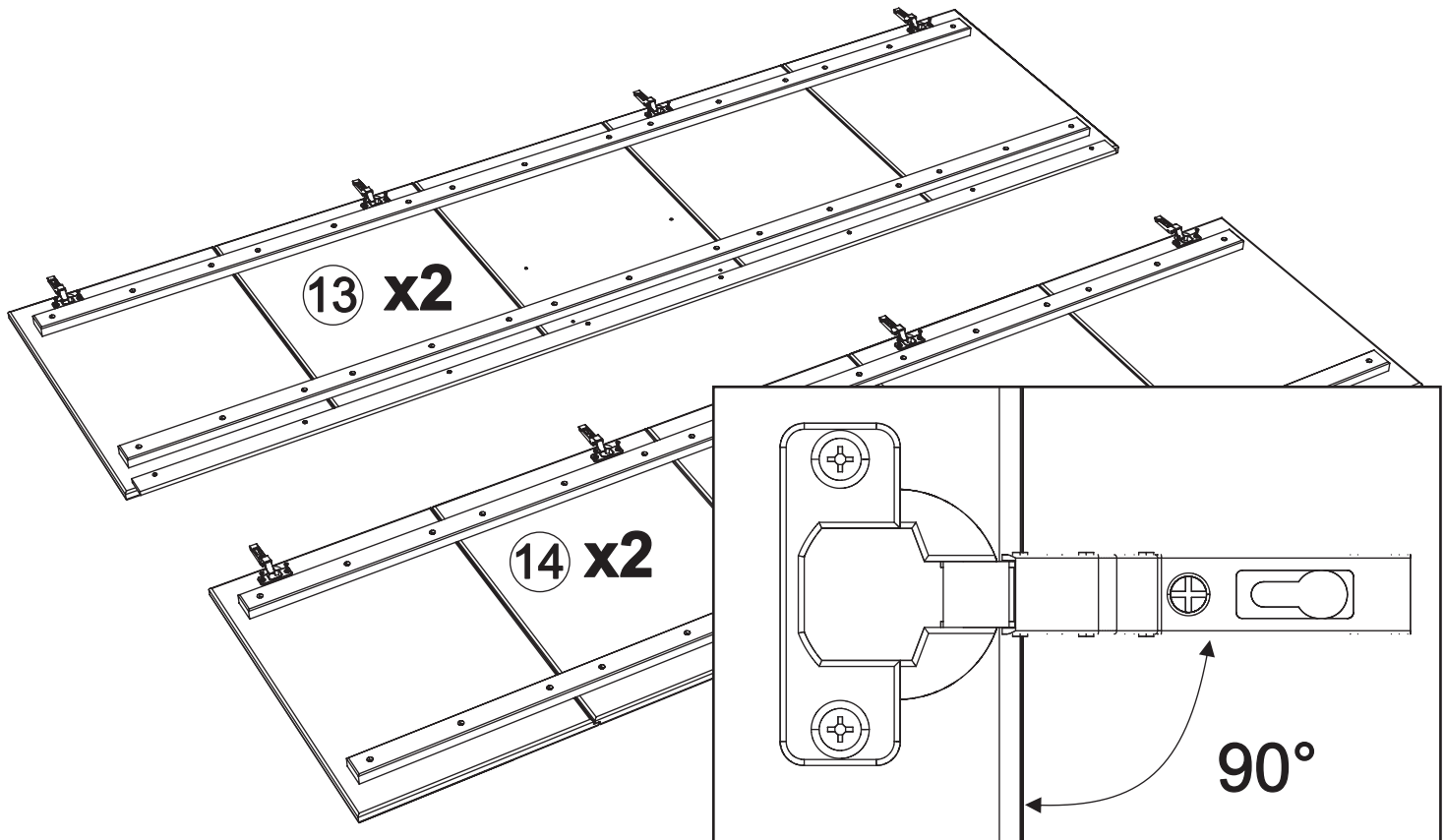
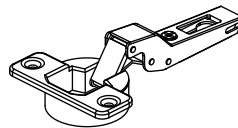
**13 x2****14 x2****90°**

19

F x 8

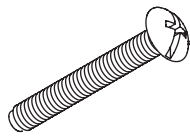

Z x 4

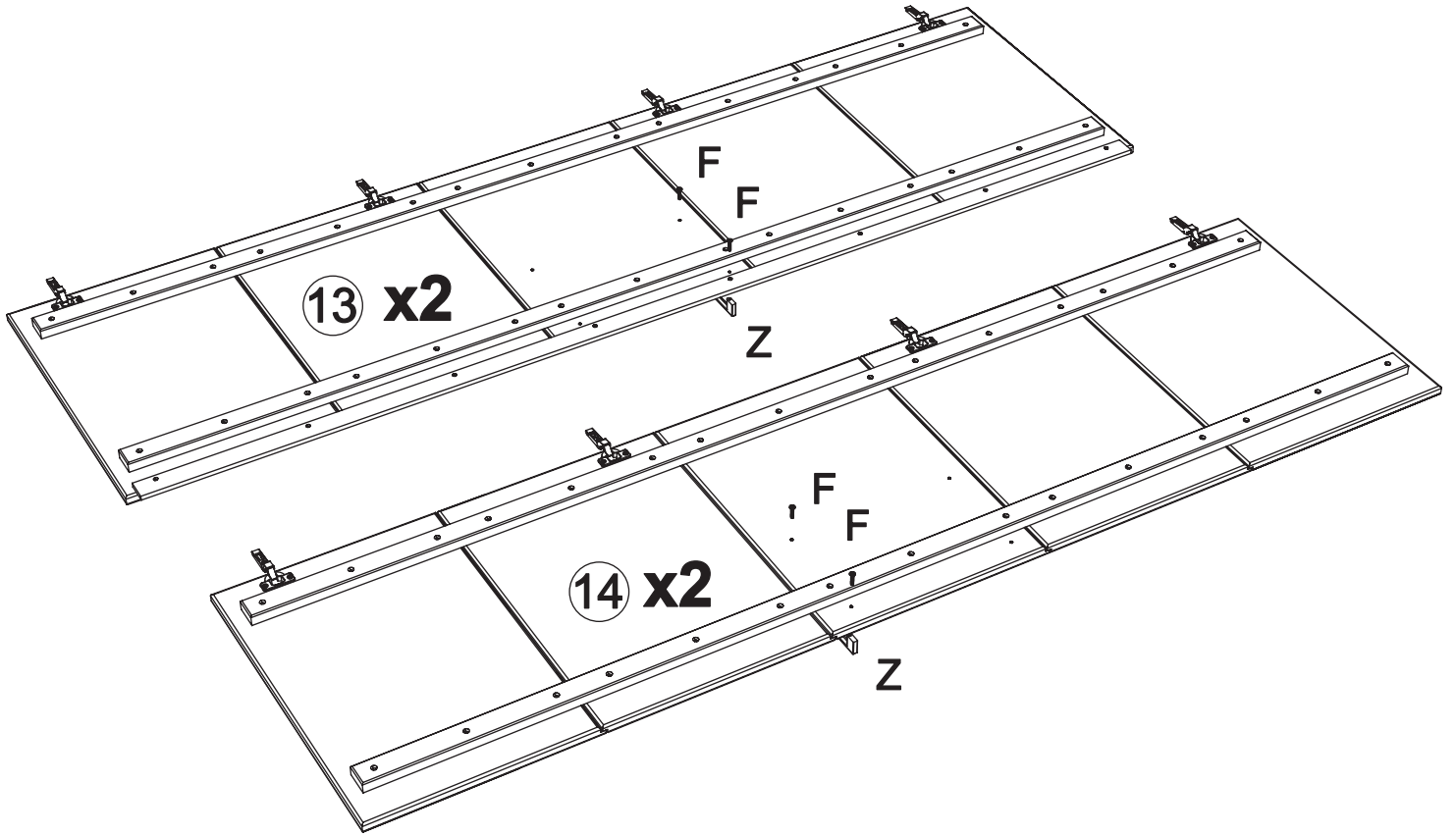

20

